

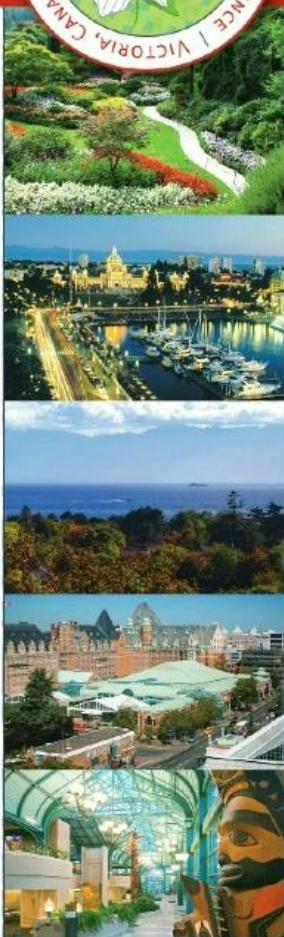

XXVIII<sup>th</sup> International Biometric Conference  
VICTORIA CONVENTION CENTRE, JULY 10 – 15, 2016



**Exhibitor Invitation**  
Victoria Conference Centre  
Victoria, British Columbia, Canada  
[www.biometricconference.org](http://www.biometricconference.org)



# XXVIII<sup>th</sup> International Biometric Conference

VICTORIA CONVENTION CENTRE, JULY 10 – 15, 2016



## Welcome Letter

The 28th International Biometric Conference (IBC) will be held in Victoria during July 10-15, 2016 at the Victoria Conference Centre, adjacent to the famous Empress Hotel. The temperate climate and relaxed island lifestyle will make for a memorable 28th IBC.

The IBC is dedicated to recent developments and application of Biometry and Statistics in many different fields of life and environmental sciences. It is held every two years in one of the 34 regions of the International Biometric Society (IBS, [www.biometricsociety.org](http://www.biometricsociety.org)). The XXXVIIIth IBC will be held in the Western North American Region (WNAR) in conjunction with the 2016 annual WNAR conference. The meeting program includes oral and poster presentations of methodological advances, applications to specific subject-matter challenges, and educational offerings.

The IBS has over 6,000 international members and the meeting brings together statisticians and others who are interested in the development and application of statistical and mathematical theory and methods to the biosciences. The Local Organizing Committee is excited to host IBC 2016 in beautiful British Columbia. We expect to attract over 800 participants from across the globe. We are confident that IBC 2016 will continue the success of IBS meetings.

Columbia. We  
across the globe.  
success of IBS

Sincerely,

Dr. Laura Cowen  
Co-Chair, Local Organizing Committee

Dr. Youyi Fong  
Co-Chair, Local Organizing Committee



# XXVIII<sup>th</sup> International Biometric Conference

VICTORIA CONVENTION CENTRE, JULY 10 – 15, 2016



## What to Expect

In 2016 the exhibit area in the Victoria Conference Centre will be located in the prefunction space directly in front of the Registration Desk and will feature:

- Morning and afternoon food & beverage areas located throughout the exhibit area
- Strategic location within the conference venue with the most foot traffic

## Eligibility & Confirmation

The IBC 2016 Local Organizing Committee through its Conference Secretariat, in its sole discretion will determine the eligibility of any applicant to exhibit at the conference. The decision of the Conference Secretariat will be final and binding. The Conference Secretariat may decline exhibit space, discontinue any promotion, wholly or in part, that in its opinion is not in keeping with the character and purposes of IBC 2016.

Upon approval of application and written confirmation of participation, accompanying benefits, invoice for payment, table top assignment and all necessary information will be provided by the Conference Secretariat. Once payment is received, an Exhibitor Kit containing shipping information and optional table top enhancements will be provided.

## Booking Policies

- Table Top assignment and confirmation will take place once full payment has been received. Upon acceptance and approval of an application for exhibit space, confirmation details will be provided in writing by the Conference Secretariat.
- The signature of an authorized signing authority is required from all exhibitors and is considered binding for all terms and conditions of exhibiting.
- While all efforts will be made to accommodate a requested exhibit space location, the Conference Secretariat reserves the right to accept or reject an application and to assign the applicant Exhibitor another space with the full understanding that if this space is not accepted by the Exhibitor within fourteen (14) days of notification, payment for space will be refunded in full without interest, prejudice or any further recourse.



## Cancellation Policy

- On or before March 1, 2016 - 50% refund
- On or after March 2, 2016 - 100% non-refundable
- Cancellations will be refunded in the form payment was made under the rules and conditions of eligibility to exhibitors.

## Summary of Key Dates

<b>March 1<sup>st</sup></b>	50% refund	
<b>March 2<sup>nd</sup> to July 10<sup>th</sup></b>	100% non-refundable	
<b>July 10<sup>th</sup></b>	Exhibit Move-In	12:00PM – 5:00PM
<b>July 11<sup>th</sup></b>	Exhibit Move-In	7:00AM – 10:00AM
<b>July 11<sup>th</sup></b>	Exhibit Area Open	10:00AM – 5:00PM
<b>July 12<sup>th</sup></b>	Exhibit Area Open	8:00AM – 5:00PM
<b>July 13<sup>th</sup></b>	Exhibit Area Open	9:00AM – 3:00PM
<b>July 14<sup>th</sup></b>	Exhibit Area Open	8:00AM – 5:00PM
<b>July 15<sup>th</sup></b>	Exhibit Area Open	8:00AM – 3:30PM
<b>July 15<sup>th</sup></b>	Exhibit Move Out	3:30PM to 7:00PM

*\* These exhibit area hours are subject to change by the Conference Secretariat.*



# XXVIII<sup>th</sup> International Biometric Conference

VICTORIA CONVENTION CENTRE, JULY 10 – 15, 2016



## Registration Form

ALL FEES IN U.S. DOLLARS

### Exhibit Space Registration

#### Fee

Single Table Top \$2,000.00 USD

### Inclusions per table top

- (2) Exhibitor Area Only passes per table top
- (1) 6' x 30" skirted table and 2 chairs
- (1) waste basket
- Overnight venue security in the exhibit area for the duration of the conference
- Daily vacuuming and general housekeeping of the exhibit common areas
- A company listing in the Conference Program
- Access to all Conference Refreshment Breaks
- Access to the Welcome Reception (Sunday, July 10<sup>th</sup>, 2016)
- Exhibitor rates for any additional conference registrations

### Additional Sponsor/Exhibitor Registrations

#### Fee

*\* once your participation is confirmed and payment is received, details on how to register will be sent via email*

- Full Delegate Registration (Discounted rate) \$ 550.00 USD
- Exhibitor Area Only (Additional fee) \$ 200.00 USD
- Gala Ticket (Thursday, July 14<sup>th</sup>, 2016) \$ 75.00 USD

First Exhibitor Name: \_\_\_\_\_ Title: \_\_\_\_\_

Second Exhibitor Name: \_\_\_\_\_ Title: \_\_\_\_\_

Organization: \_\_\_\_\_

Address: \_\_\_\_\_

Phone: \_\_\_\_\_ Email: \_\_\_\_\_

Signature: \_\_\_\_\_

Please return completed form to:

**International Biometric Society | Dee Ann Walker, Executive Director**

[dawalker@bostrom.com](mailto:dawalker@bostrom.com) | 1444 I Street, NW, Suite 700, Washington, DC 20005 USA



# XXVIII<sup>th</sup> International Biometric Conference VICTORIA CONVENTION CENTRE, JULY 10 – 15, 2016



## Exhibit Area Floor Plan

Victoria Conference Centre – Prefunction 1A, Level One

*\* all meetings will be held on Levels 1 and 2 of the conference centre*

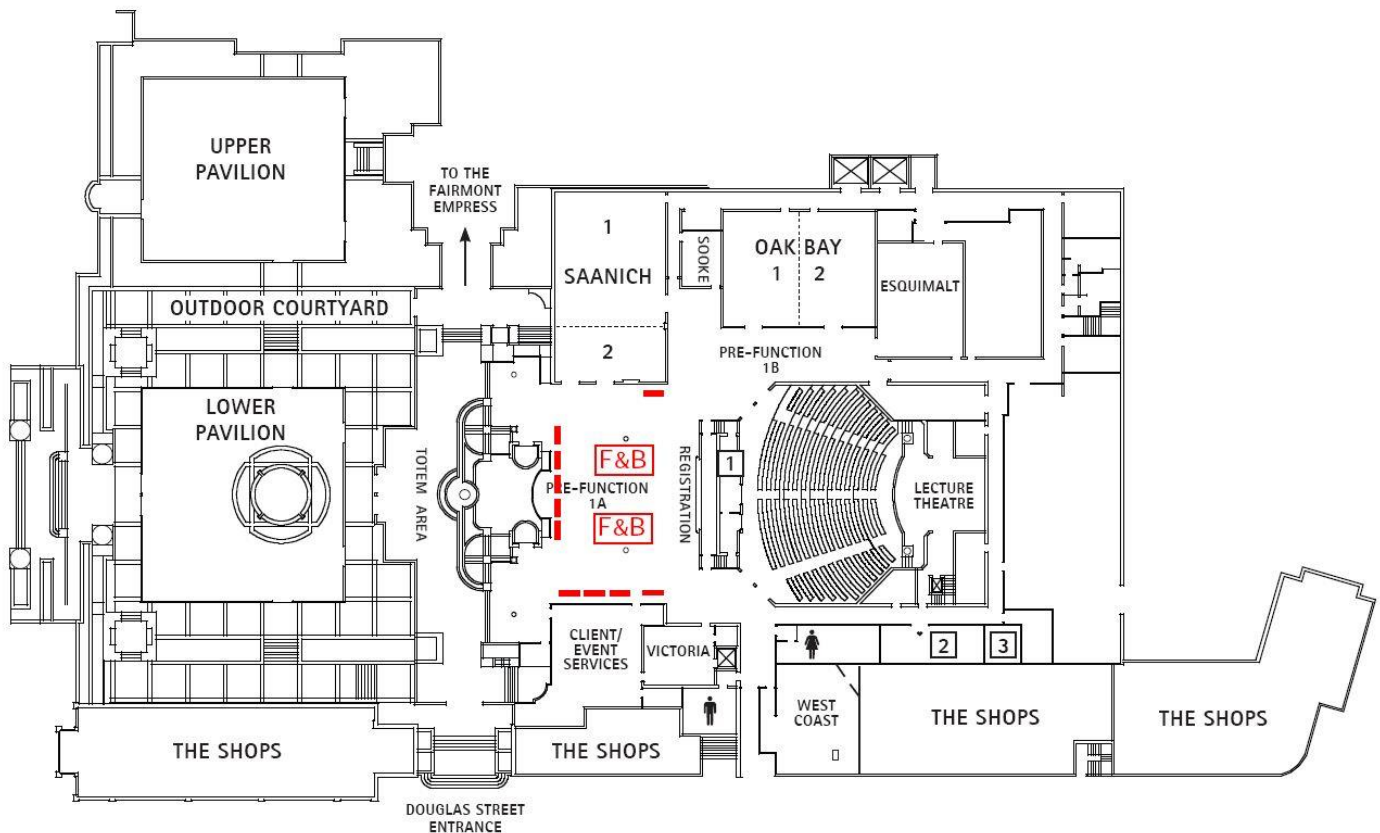

*\* floorplan subject to change by Conference Secretariat*

## Exhibitor Questions

Space is limited so please register for your selection as early as possible to avoid disappointment. If you have any questions about participating as an exhibitor please contact: Dee Ann Walker, Executive Director at [dawalker@bostrom.com](mailto:dawalker@bostrom.com).